

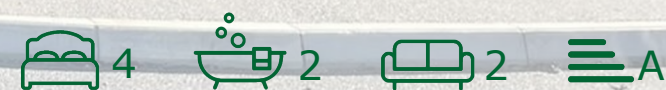

17 Chapel End, Hartpury, GL19 3FH
£599,950



17 Chapel End, Hartpury, GL19 3FH

This brand new four-bedroom detached house is a splendid opportunity for modern family living. designed with both comfort and style in mind.

The heart of the home features a contemporary kitchen that seamlessly integrates with the living spaces, creating an inviting atmosphere. With four well-proportioned bedrooms with the main benefitting an ensuite.

Built to a high specification, this home is equipped with an air source heat pump solar panel and EV charging point promoting energy efficiency and sustainability.

The garage provides additional storage or parking options, while the driveway accommodates ample parking.

Area Map



Floor Plan

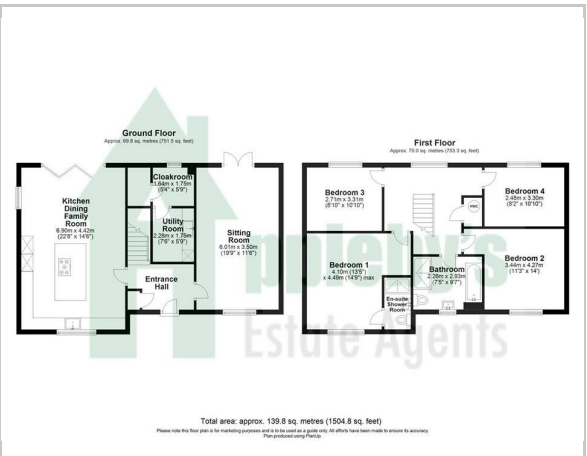

The Situation

Entrance Hall

Kitchen/Dining
22'10 x 14'9 (6.96m x 4.50m)

Living Room
19'11 x 11'5 (6.07m x 3.48m)

Utility
7'5 x 5'7 (2.26m x 1.70m)

Bedroom 1
14'9 x 13'7 (4.50m x 4.14m)

Ensuite

Bedroom 2
11'4 13'7 (3.45m 4.14m)

Bedroom 3
11'0 x 9'0 (3.35m x 2.74m)

Bedroom 4
10'10 x 8'3 (3.30m x 2.51m)

Bathroom

OUTSIDE

Services

Tenure



Energy Efficiency Graph

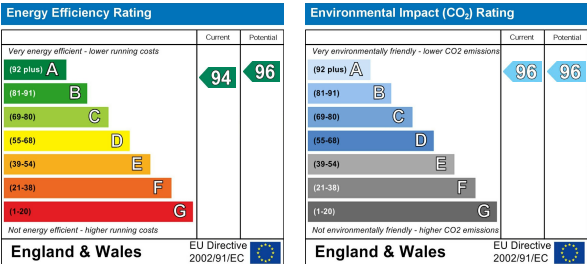

These particulars, whilst believed to be accurate are set out as a general outline only for guidance and do not constitute any part of an offer or contract. Intending purchasers should not rely on them as statements of representation of fact, but must satisfy themselves by inspection or otherwise as to their accuracy. No person in this firms employment has the authority to make or give any representation or warranty in respect of the property.